

## 6 LOW HEADROOM HOIST NC, REEVING: 04, EXTENDED LOAD

### Hoist dimensions

HOL m	Length code	M1 mm	H2 mm	H3 mm	H3* mm	BUF mm	Weight kg
6	B	356	49	574	590	524	330
9	C	456	74	574	590	624	350
12	D	556	99	574	590	724	370

### Motor dimensions

Motor	P3	A3	S3
MOT (mm)	473	443	523
Weight (kg)	35	32	28

### Trolley dimensions

B min.	B max.	ØWD	ØBU	BU	BUH	E1	E2	GEA	H1	H4	TD
100	490	125	63	195	41	56	568	116	366	538	190
TF	TH	TW									
42	253	42									

D002093\_A  
062511

### C-dimensions

B	C
100 - 199	505
200 - 249	470
250 - 300	440
301 - 350	475
351 - 400	505
401 - 450	540
451 - 490	570

Note: All dimensions in mm.

Note: Weight calculated with P3 motor.

\* Please, disregard the dimension H3\*.

Low Headroom Hoist NC, REEVING: 04, Extended Load

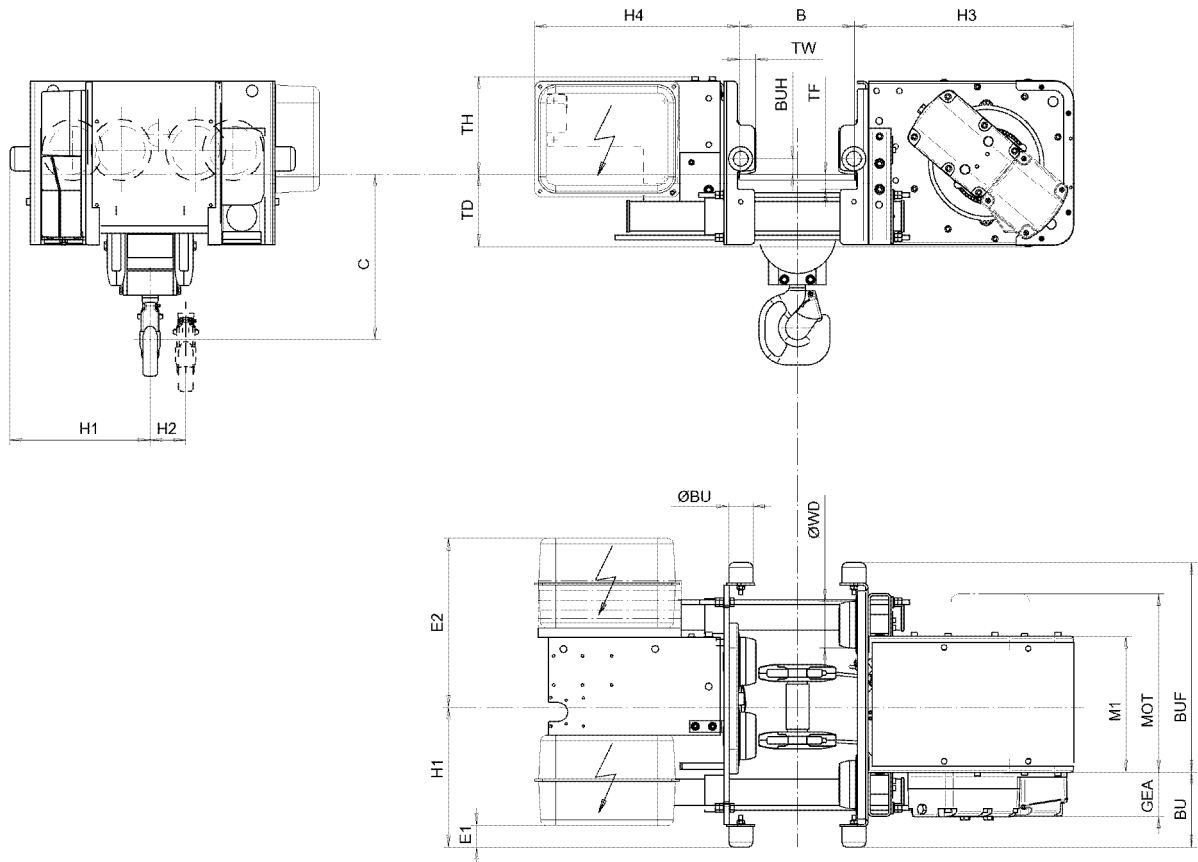

D002093-A